

### FEATURES

- Direct acting valves with stainless steel seat ensure a long continuous cycling life in severe steam applications
- The solenoid valves have forged brass bodies, compact design, to minimize heat radiation parts
- Core disc design
- The solenoid valves are constructed packless with a one-piece deepdrawn stainless steel core tube, ensuring safe operation of electrical and wetted moving parts
- The solenoid valves satisfy all relevant EC Directives

### GENERAL

Differential pressure

See "SPECIFICATIONS" [1 bar = 100 kPa]

Response times

5 - 25 ms

fluids (*)	temperature range (TS)	seal materials (*)
hot water, steam	- 20°C to + 150/160/165°C	PTFE - reinforced

### MATERIALS IN CONTACT WITH FLUID

(\*) Ensure that the compatibility of the fluids in contact with the materials is verified

Body	Brass
Core tube	Stainless steel
Core and plugnut	Stainless steel
Springs	Stainless steel
Seat	Stainless steel
Seals	EPDM
Disc	PTFE reinforced
Shading coil	Copper

### ELECTRICAL CHARACTERISTICS

Coil insulation class

F

Connector

Spade plug (cable Ø 6-10 mm)

Connector specification

ISO 4400 / EN 175301-803, form A

Electrical safety

IEC 335

Electrical enclosure protection

Moulded IP65 (EN 60529)

Standard voltages

DC (=) : 24V - 48V

(Other voltages and 60 Hz on request)

AC (~) : 24V - 48V - 115V - 230V / 50 Hz

prefix option	power ratings				operator ambient temperature range (TS)  (C°)	replacement coil		type <sup>(1)</sup>
	inrush ~	holding ~		hot/cold =		~	=	
	(VA)	(VA)	(W)	(W)		230 V/50 Hz	24 V DC	
SC	55	23	10,5	-	-20 to + 40	400425-117	-	01
	-	-	-	12/16.8	-20 to + 40	-	400625-142	02

<sup>(1)</sup> Refer to the dimensional drawings on the following page.

### SPECIFICATIONS

pipe size	orifice size	flow coefficient Kv		operating pressure differential (bar)				max. fluid temp.		power coil (W)		catalogue number	
				min.	max. (PS)								
					steam (*)		water (*) <sup>(2)</sup>						(°C)
Rp	(mm)	(m³/h)	(l/min)		~	=	~	=	~	=			
NC - Normally closed													
1/4	4	0,45	7,5	0	6	3,5	6	3,5	165	150	10,5	16,8	SCE263A300
	5,6	0,62	10,8	0	5	-	5	-	160	-	10,5	-	SCE263A301
3/8	4	0,45	7,5	0	6	3,5	6	3,5	165	150	10,5	16,8	SCE263A305
	5.6	0.62	10.8	0	5	-	5	-	160	-	10.5	-	SCE263A306

<sup>(2)</sup> Water temperature should not exceed 100°C.

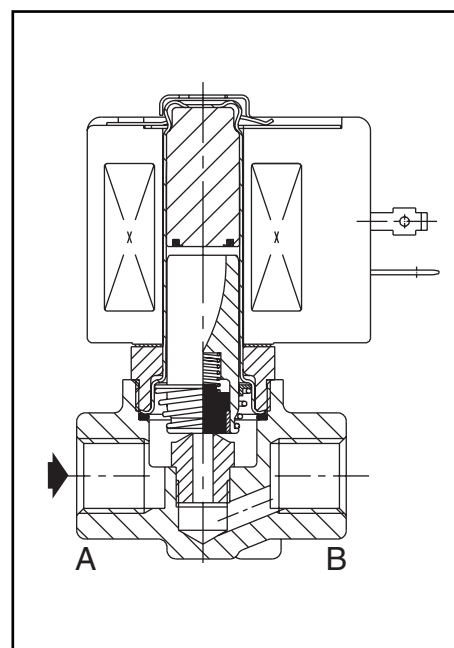

### OPTIONS

- Waterproof enclosure with embedded screw terminal coil according to protection class IP67, CEE-10
- Electrical enclosures according to "NEMA" standards are available
- Compliance with "UL", "CSA" and other local approvals available on request
- Other pipe connections are available on request
- Plug with visual indication and peak voltage suppression or with cable length of 2m (see Solenoids, Coils & Accessories section)

### INSTALLATION

- The solenoid valves can be mounted in any position without affecting operation
- Solenoid valves have 2 mounting holes in body
- Pipe connection identifier is E = Rp (ISO 7/1)
- Installation/maintenance instructions are included with each valve

### SPARE PARTS KIT

catalogue number	spare parts kit n°.	
	~	=
SCE263A300/305	<b>C186270</b>	<b>C132650</b>
SCE263A301/306	<b>C186270</b>	-

- Not available.

### ORDERING EXAMPLES:

<b>SC</b>	E	263	<b>A</b>	300	230V / 50 Hz
<b>SC</b>	E	263	<b>A</b>	301	115V / 50 Hz
<b>SC</b>	E	263	<b>A</b>	305	24V / DC
<b>SC</b>	E	263	<b>A</b>	306	230V / 50 Hz

prefix — pipe thread — basic number — voltage — suffix

### ORDERING EXAMPLES KITS:

	C186270	
	C132650	

basic number — suffix

### DIMENSIONS (mm), WEIGHT (kg)



#### TYPE 01-02

Prefix "SC" Solenoid  
Epoxy moulded  
IEC 335 / ISO 4400  
IP65

Type 01 (AC): SCE263A300/301/305/306

Type 02 (DC): SCE263A300/305

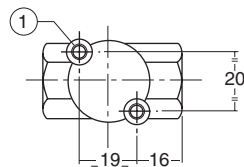
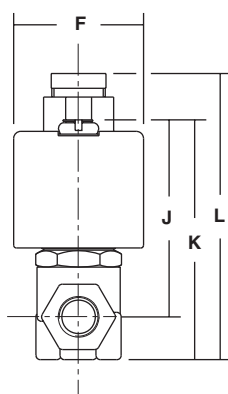
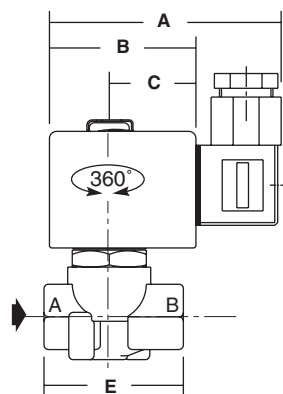

① 2 mounting holes Ø M5, depth 6 mm.

type	prefix option	A	B	C	E	F	J	K	L	weight <sup>(1)</sup>
01	SC	80	50	30	48	45	67	82	99	0,70
02	SC	86	56	33	48	50	75	90	90	0,80

<sup>(1)</sup> including coil and connector.

All leaflets are available on: [www.asconumatics.eu](http://www.asconumatics.eu)

V901-09-2